

4 continued

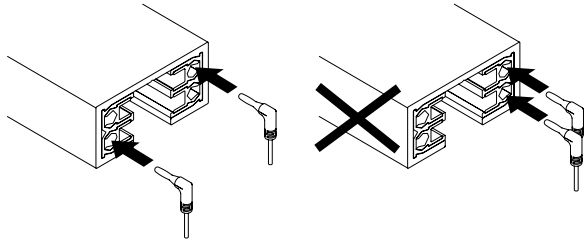

Ensure the correct connection between the tracks as following:



5

Stick the covers in order to hide the connection of power plug and the other end.

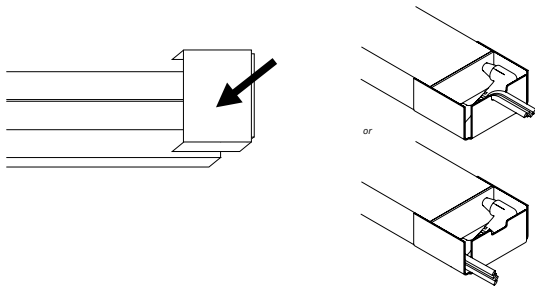

6

Connect the pairs of XPR fixations to the track(s).

6-1 Push the fixation until its shoulder touch the open.

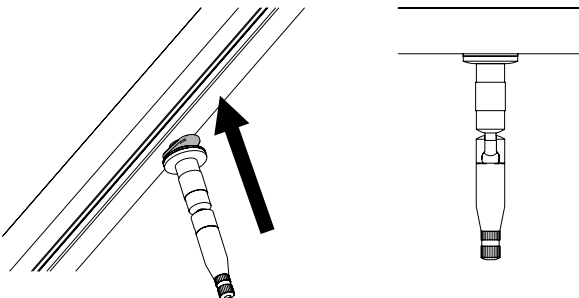

6 continued

6-2 Turn the fixation until it stops. Must fixed so top part is not visible from bottom view (see below images).

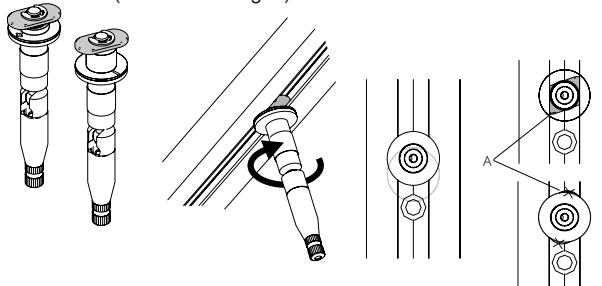

7

Assembling the cables.

7-1 Loosen the screw from the nosecone.

7-2 Press on the sides of the screw and insert cable through the nosecone.

7-3 Let go of the screw to maintain the cable at the desired height.

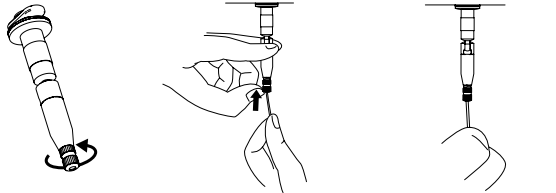

7-4 Tighten the screw back onto the nosecone.

7-5 Cut the cables.



8

Plug-in the main power supply cable (on a 60, 90 or 150 watt power supply or connected to a v POWER BOX).

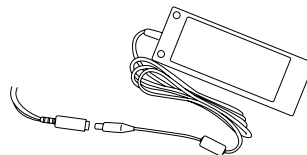

RAIL TRACK User Guide



European and International Standard



If you need help, you can contact our After Sale Service. Before contacting VitrineMedia, please write down the product model and serial number.

You can find these informations directly on the product or on the packaging.

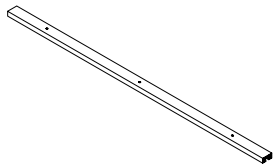

X Power Rail Track (x1)

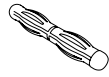

Banana Joint (x4)



Track Seam Cover (x1)

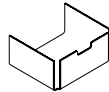

Track End Cover (x2)

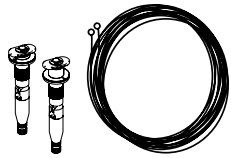

Column Cable Kit (pair)
(not supplied)



XPR POWER CORD
(not supplied)

Recommended Tools

- Drill
- Wire cutter
- Measuring Tape
- Level
- Screw driver
- Hacksaw
- Appropriate wall anchors
(countersunk flat head screw)

Safety notice

Check that all connections are functioning properly (plugs connected correctly)

1

Mark the holes positions on the support if need for dowels (not supplied).

- When measuring the rail, do not forget to include the end caps and joints in the total length.
- In case the rail needs to be cut, ensure that no metallic particles remain behind.

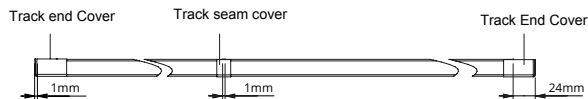

Mark the holes positions on the support if need for dowels (not supplied).

1

continued

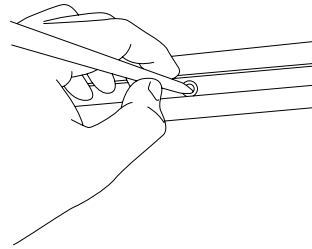

WARNING:

- The size of the hole must not be larger than the size of the screw.
- Plan for at least two screws per section.
- If drilling additional holes, be sure to remove all metallic particle residue.
- If the drill holes aren't positioned in the right places; make additional holes in the rail using a drill and a steel bit. Ensure that the fixture heads of the cable do not touch the fixture screw heads.

2

Drill the support (wall or ceiling) and install the anchors (not included).



3a

In the case of assembling a single track:

3a-1 Fix the rail to the support using M5 or ST4.8 screws.

3b

In the case of assembling two or more tracks:

3b-1 Fix to the support with M5 or ST4.8 screws, the rail to which the power cord is plugged.

3b-2 Plug four banana joints into the next rail.

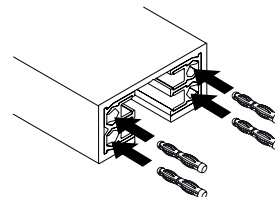

3b

continued

3b-3 Plug the next rail into the fixed rail.

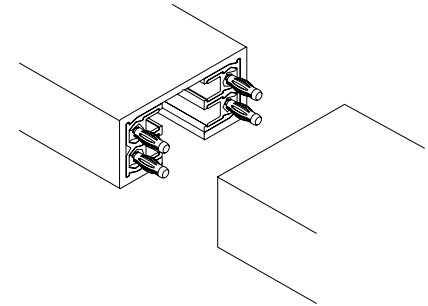

3b-4 Fix the new rail to the support.

3b-5 Remove the adhesive tape from the rail cover, and place it at the junction of the two rails.

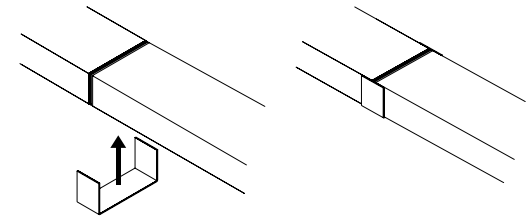

3b-6 Repeat the operations 3b-2 to 3b-5 for the additional track.

NB : After three consecutive rails, we recommend that you add a power supply at the other end.

4

Connect XPR power cord according to the following images:

